

Owner's Manual

TowerOne

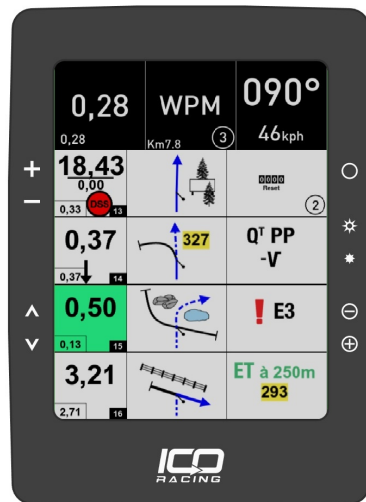

Contents

Basics	2
Mechanical Assembly	3
Electrical Connections	4
Buttons	5
Menu - Trip	6
Menu - Waypoints	7
Menu - Routes	7
Menu - Connect	8
Menu - Settings	9-11
Navigation	12-13
Updates	14

www.icoracing.com

+1 503 567 2214

customer_service@icoracing.com

Quickstart

Load a roadbook and/or waypoint files.

Wifi

Turn on the Towerone Wifi Access Point by opening the menu

Upload the files using the web interface

USB

Insert a flash drive with the files into the USB port

copy the files to the Towerone using the menu

Select the files to navigate.

Towerone supports both combined and separate files for the roadbook and waypoints

Ride!

Mechanical Assembly

Mount Arm Assembly

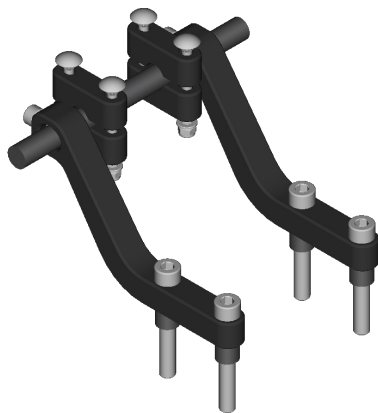

The mount arms accommodate handbar clamps that use M8 bolts on 38-40mm spacing. The bolt length should be checked for proper thread engagement in the bar clamp.

Isolator Assembly

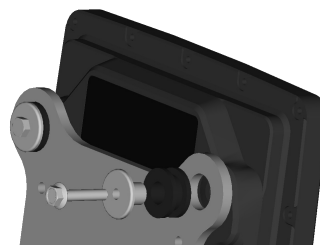

If the supplied isolator plate is not used, another plate or bracket with 5mm thickness can be used. The mounting holes are 16mm diameter on a 120x150mm rectangular pattern. Please provide clearance for the buttons on the side and the cables on the bottom.

Electrical Connections

Left

A standard rally 3 pin remote

Center

An ICO 4 pin remote or a standard rally roadbook switch

Right

A standard rally 3 pin remote or a wheel sensor

Output

Buzzer

GPS

GPS antenna. Mount it at least 20cm/8" from any RF transmitters

Power

Connect to 12V power. Recommended fuse is 5 to 10 Amps.

Reversed polarity will not function but will not cause damage.

Left,Center,Right are grey connectors.

Output and GPS are black connectors.

Power is a red connector.

USB

Connect a flash drive to upload roadbooks. Do not leave the drive installed while riding.

Buttons

The buttons on the display are in the back, behind their icon on the front panel.

FORWARD and REVERSE refer to the roadbook

BRIGHT and DIM refer to the display backlight

PREVIOUS and NEXT refer to the selected waypoint

Pressing ODO+ and ODO- together is treated as a press of SET

Pressing FORWARD and REVERSE together is treated as a press of MARK

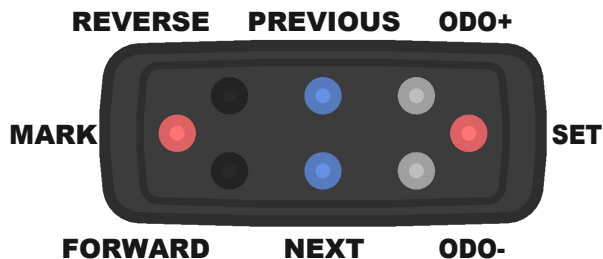
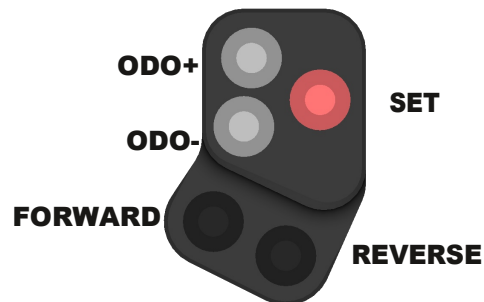

Menu

Enter and exit the menu by pressing the Menu button

Hints for the menu functions are shown on the screen adjacent to their buttons

QR codes

Displayed when Wifi is active. The left is for connecting to the TowerOne, the right is for bringing up the TowerOne's web page.

Roadbook and Waypoints

The name of the currently loaded roadbook and waypoint files.

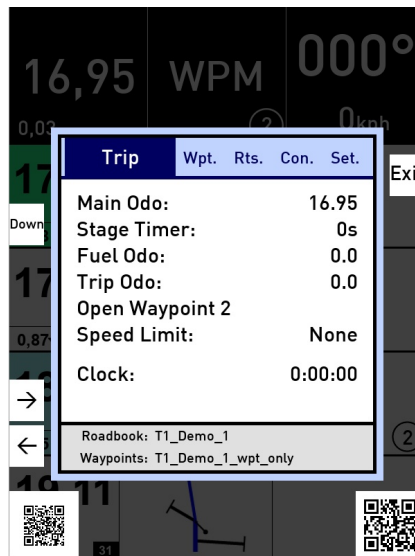

Trip	Wpt.	Rts.	Con.	Set.
Main Odo:	16.95			
Stage Timer:	0s			
Fuel Odo:	0.0			
Trip Odo:	0.0			
Open Waypoint 2				
Speed Limit:	None			
Clock:	0:00:00			
Roadbook: T1_Demo_1				
Waypoints: T1_Demo_1_wpt_only				

Trip Page

Main Odo

The device's main odometer.

Stage Timer

A timer that starts when you first move after manually resetting the odometer.

Fuel and Trip Odo

Odometers that are not adjusted with the Main Odo. They can be reset independently in this menu.

Open Waypoint

Allows the current waypoint to be forced open.

Speed Limit

The current speed limit, it can be manually disabled.

Clock

The current time.

Waypoints

All the waypoints in the route are shown. Validated waypoints are highlighted in grey with the validation time shown. The currently selected waypoint is boxed in blue.

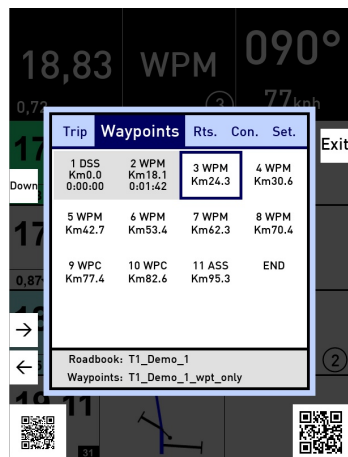

Trip	Waypoints	Rts.	Con.	Set.
1 DSS	2 WPM	3 WPM	4 WPM	
Km0.0	Km18.1	Km24.3	Km30.6	
0:00:00	0:01:42			
5 WPM	6 WPM	7 WPM	8 WPM	
Km42.7	Km53.4	Km62.3	Km70.4	
9 WPC	10 WPC	11 ASS	END	
Km77.4	Km82.6	Km95.3		

Roadbook: T1_Demo_1
Waypoints: T1_Demo_1_wpt_only

Routes

Pdf,Gpx,Zip,Enc

Files that are stored on the Towerone are selected here.

Options

PDF options take effect when loading the roadbook, Openrally options take effect immediately

PDF Trim Roadbook Pages

Remove header and footers from the pages of a roadbook.

PDF Index Roadbook Rows

Scan the PDF and index the forward/reverse scroll functions

Openrally Large Format

Rearranges the roadbook rows for easier viewing

Openrally Hide Hundredths, Small Hundredths, Small Hundreds

Changes the format of the distance field in the roadbook

Openrally Clear Roadbook, Clear Waypoints

Unload the current files from use.

Reset Progress

Changes all the validated waypoints back to unvalidated.

Erase All Route Files

Deletes all the roadbook and waypoint files saved on the Towerone. It requires entering a passcode to confirm.

Connect

Wifi

Enable Wifi

Turn on Wifi

Menu starts Wifi

Wifi turns on automatically when in the menu

Enable Wifi

Password, Wifi

Password

Use secure wifi, the password is limited to an 8 digit number

USB

Copy All

Copy all Pdf,Gpx,Zip,Enc files from usb drive to internal storage

Individual files

Copy file to internal storage. Checked files are already copied.

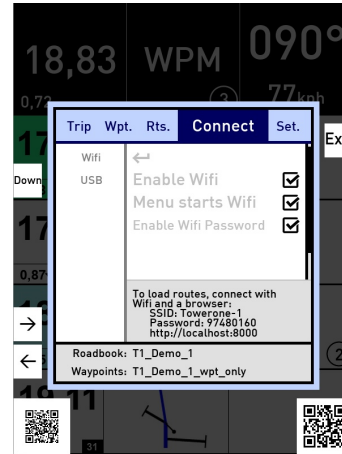

Settings

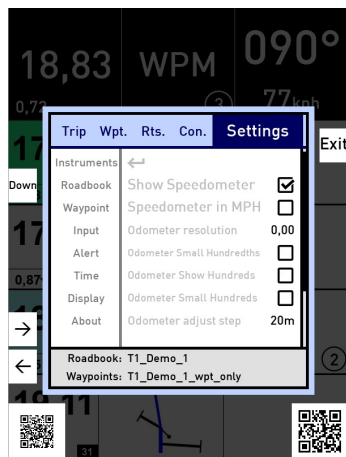

Instruments

Show Speedometer

Display speed below the compass

Speedometer in MPH

Display the speed in miles per hour instead of Kph. This only affects the speed display, it does not affect the speed or speed limit shown in speed zones, nor does it affect the odometer or distances.

Odometer Resolution

Show the odometer in either tenths or hundredths of a kilometer

Odometer Small Hundredths

Make the odometer hundredths digit smaller than the others

Odometer Show Hundreds

Show the hundreds digit in the odometer

Odometer Small Hundreds

Make the odometer hundreds digit smaller than the others

Odometer Adjust Step

How much to change the odometer for each press of Odo+ or Odo-.

Partial Odometer is primary

Switch the position of the partial and main odometer

Show Partial Odometer

Display the partial odometer

Enable Reversible Odo

Open an option in the Set screen to allow the odometer to count distance either up or down.

Settings

Roadbook

Show Previous Instruction

The first row of the roadbook is displayed with a dark grey cover. Roadbook Mark and Odometer Set functions operate on the second row.

Set Main Odo from RB

Pressing SET copies the full distance value from the current roadbook row to the odometer

Set Partial Odo from RB

Pressing SET copies the partial distance value from the current roadbook row to the partial odometer, instead of resetting the partial odometer to zero

Odo-RB Set Limit

If setting the odometer from the roadbook when the change is more than this limit value, turn the odometer digits red instead of setting the odometer. A second press of SET while the digits are red will set the odometer.

Set Marks RB

Pressing SET also marks the roadbook

Set Scrolls RB

Pressing SET also advances the roadbook to the next instruction

Mark Enabled

Allows marking the roadbook (placing a grey slash across the roadbook distance field)

Mark Also Scrolls RB

Pressing MARK also advances the roadbook to the next row

Mark Also Resets Partial

Pressing MARK also resets the partial odometer to zero

Bookmark Enabled

Allows the use of the bookmark function. On a roadbook row that is unmarked: hold MARK until the roadbook reversed back to the first marked row

Waypoint

Set Odometer at Wpt

Main odometer is automatically adjusted when the waypoint is validated

Auto Advance Wpt

The next waypoint is automatically selected when a waypoint is validated

Fast Advance Wpt

Auto Advance does not occur until after driving away from the validated waypoint

Settings

Input

Left,Center,Right Remote Inputs

Set the function of the three grey cables

Wheel Circumference

Set the circumference of the wheel (in mm)

Wheel Sensor Only

Use only the wheel sensor for odometer and speed input, the compass and waypoints still use GPS if available

RB Button Delay

How long to wait after the first press of FORWARD or REVERSE before repeated scrolling. Use a lower number for tactile switches and a higher number for toggle switches, especially ones that are worn.

Display

Auto Dim Display

When stopped and no buttons have been pressed for 5 seconds, reduce the display brightness one step from fully bright in order to save power

Show Clock

Display a stage timer and time of day clock at the bottom of the screen. The stage timer is reset when the odometer is reset, and starts after riding 50 meters

Instruments on Bottom

Place the instruments at the bottom of the screen instead of the top

Hide Instruments

Don't show instruments at all, only the roadbook

Alert

Alert Volume

Set the volume for the beeper

Test Alert

Beep once

Time

Set Local Time Zone

Change the time from GPS (UTC) time to the local time

About

Serial Number

Towerone Serial Number

Device ID

Internal CPU Serial Number

Software Version

Navigate without Waypoints

Full Odometer

Adjusts With Odo +/- buttons

Partial Odometer

Adjusts with Full Odometer

Resets to zero with a press on the Set button

Speed

Compass

Roadbook

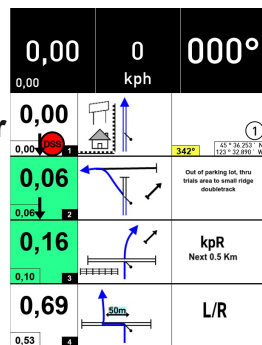

Set Odometer to New Value

Hold Set to start

Press Set to cycle arrow

Use odo+/- to cycle value

Hold Set to finish

Reset sets to 0.00

Set sets to chosen value

Undo restores original value

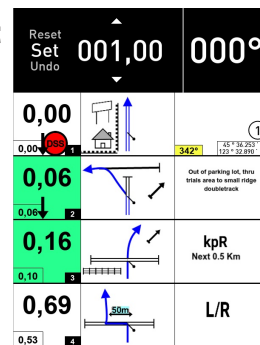

Navigate to Closed Waypoint

WPM:

Waypoint Type

KM18.1:

Waypoint Distance

2:

Waypoint Number



Navigate to Open Waypoint

>99km:

Distance to Waypoint

244°

Bearing to Waypoint

Center Arrow:

Direction to Waypoint

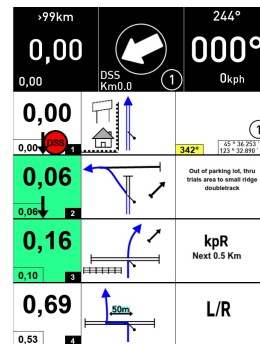

Out of Order Waypoint

After missing a waypoint and then entering the opening radius of the next waypoint, an alert will appear.

In this case, Waypoint number 2 (WPM at Km18.1) was missed, and Waypoint 3 (WPM at 24.32) is close enough to open if it is selected.

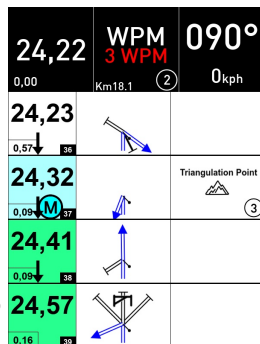

Reverse Odometer

Hold SET to bring up set function, select Reverse. The odometer will now count down when you travel instead of up. ODO+ and ODO- are unchanged. To return to the normal function, hold SET and select Forward.

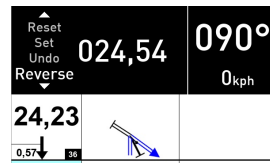

When the odometer is reversed, the display will be black on white and "Reverse Odo" will be displayed.



Software Update

Copy the new software to a USB flash drive or upload it to the Towerone using the Wifi interface.

It will be a file named t1update-Version-Checksum.zip

Turn off the Towerone

Press and hold MENU

Turn on the Towerone

Wait for the software recovery screen to start (about 10 seconds)

Release MENU

Use the ODO+/ODO- buttons to select the new version of software to use

Press NEXT to select the version

Press PREVIOUS to confirm the action

Pressing any other button will exit the recovery screen without making changes

The remote buttons have no effect

ICO Racing

www.icoracing.com

customer_service@icoracing.com

+1 503 567 2214 (GMT -8:00)

Beaverton Oregon USA